

Single Straight Coolant Hole Rods

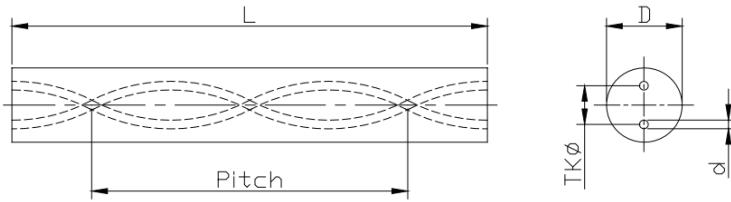

OD(mm)	OD Tol.(mm)	Inner Hole d(mm)	ID Tol. (mm)	Hole center diviation value α	Length (mm)	L Tol. (mm)	Item No.
3	+0.50/+0.30	0.5	± 0.10	0.1	330	1.5	1H00001
4	+0.50/+0.30	0.8	± 0.10	0.1	330	1.5	1H00002
5	+0.50/+0.30	0.8	± 0.10	0.13	330	1.5	1H00003
6	+0.50/+0.30	1	± 0.15	0.15	330	1.5	1H00004
7	+0.60/+0.30	1	± 0.15	0.15	330	1.5	1H00005
8	+0.60/+0.30	1	± 0.15	0.15	330	1.5	1H00006
9	+0.60/+0.30	1.4	± 0.15	0.2	330	1.5	1H00007
10	+0.60/+0.30	1.4	± 0.15	0.2	330	1.5	1H00008
11	+0.60/+0.30	1.4	± 0.15	0.28	330	1.5	1H00009
12	+0.60/+0.30	1.8	± 0.15	0.3	330	1.5	1H00010
13	+0.70/+0.30	1.8	± 0.15	0.34	330	1.5	1H00011
14	+0.70/+0.30	1.8	± 0.15	0.37	330	1.5	1H00012
15	+0.70/+0.30	2	± 0.20	0.4	330	1.5	1H00013
16	+0.70/+0.30	2	± 0.20	0.4	330	1.5	1H00014
17	+0.80/+0.30	2	± 0.20	0.47	330	1.5	1H00015
18	+0.80/+0.30	2	± 0.20	0.5	330	1.5	1H00016
19	+0.80/+0.30	2	± 0.20	0.5	330	1.5	1H00017
20	+0.80/+0.30	2.5	± 0.25	0.5	330	1.5	1H00018
21	+0.80/+0.30	2.5	± 0.25	0.5	330	1.5	1H00019
22	+0.80/+0.30	2.5	± 0.25	0.5	330	1.5	1H00020
23	+0.80/+0.30	3	± 0.25	0.5	330	1.5	1H00021
24	+0.80/+0.30	3	± 0.25	0.5	330	1.5	1H00022
25	+0.80/+0.30	3	± 0.25	0.5	330	1.5	1H00023
26	+0.80/+0.30	3	± 0.25	0.5	330	1.5	1H00024
27	+0.80/+0.30	3	± 0.25	0.5	330	1.5	1H00025
28	+0.80/+0.30	3	± 0.25	0.5	330	1.5	1H00026
29	+0.80/+0.30	3	± 0.25	0.5	330	1.5	1H00027
30	+0.80/+0.30	3	± 0.25	0.5	330	1.5	1H00028

30 Degree/ 40 Degree Double Coolant holes Rods in



OD Ø(mm)	OD Tol.(mm)	Inner d(mm)	ID Tol. (mm)	Distance between holes		Hole center deviation value α	L (mm)	Tol.(mm)	30-Deg	40-Deg
				mm	Tol.(mm)				Item No.	Item No.
4	+0.50/+0.30	0.8	±0.10	1.8	+ 0/-0.15	0.1	330	1.5	2H30001	2H40001
5	+0.50/+0.30	0.8	±0.10	2	+ 0/-0.15	0.13	330	1.5	2H30002	2H40002
6	+0.50/+0.30	1	±0.15	3	+ 0/-0.20	0.15	330	1.5	2H30003	2H40003
7	+0.60/+0.30	1	±0.15	3.5	+ 0/-0.20	0.15	330	1.5	2H30004	2H40004
8	+0.60/+0.30	1	±0.15	4	+ 0/-0.30	0.15	330	1.5	2H30005	2H40005
9	+0.60/+0.30	1.4	±0.15	4	+ 0/-0.30	0.2	330	1.5	2H30006	2H40006
10	+0.60/+0.30	1.4	±0.15	5	+ 0/-0.30	0.2	330	1.5	2H30007	2H40007
11	+0.60/+0.30	1.4	±0.15	5	+ 0/-0.30	0.28	330	1.5	2H30008	2H40008
12	+0.60/+0.30	1.75	±0.15	6	+ 0/-0.30	0.3	330	1.5	2H30009	2H40009
13	+0.70/+0.30	1.75	±0.15	6	+ 0/-0.30	0.34	330	1.5	2H30010	2H40010
14	+0.70/+0.30	1.75	±0.15	7	+ 0/-0.30	0.37	330	1.5	2H30011	2H40011
15	+0.70/+0.30	2	±0.20	7	+ 0/-0.30	0.4	330	1.5	2H30012	2H40012
16	+0.70/+0.30	2	±0.20	8	+ 0/-0.30	0.4	330	1.5	2H30013	2H40013
17	+0.80/+0.30	2	±0.20	8	+ 0/-0.30	0.47	330	1.5	2H30014	2H40014
18	+0.80/+0.30	2	±0.20	9	+ 0/-0.30	0.5	330	1.5	2H30015	2H40015
19	+0.80/+0.30	2	±0.20	9	+ 0/-0.30	0.5	330	1.5	2H30016	2H40016
20	+0.80/+0.30	2.5	±0.25	10	+ 0/-0.40	0.5	330	1.5	2H30017	2H40017
21	+0.80/+0.30	2.5	±0.25	10	+ 0/-0.40	0.5	330	1.5	2H30018	2H40018
22	+0.80/+0.30	2.5	±0.25	11	+ 0/-0.40	0.5	330	1.5	2H30019	2H40019
23	+0.80/+0.30	2.5	±0.25	11	+ 0/-0.40	0.5	330	1.5	2H30020	2H40020
24	+0.80/+0.30	3	±0.25	12	+ 0/-0.50	0.5	330	1.5	2H30021	2H40021
25	+0.80/+0.30	3	±0.25	12	+ 0/-0.50	0.5	330	1.5	2H30022	2H40022
26	+0.80/+0.30	3	±0.25	13	+ 0/-0.50	0.5	330	1.5	2H30023	2H40023

30 Degree/ 40 Degree Triple Coolant Hole Rods

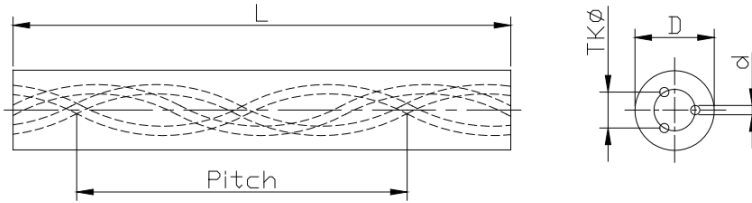

Outer D(mm)	OD Tol.(mm)	Distance betw een holes TK (mm)	Distence Tol. (mm)	Inner d (mm)	ID (mm)	Pitch (mm)	Pitch Tol. (mm)		Length (mm)		30-Deg Item No.	40-Deg Item No.
6	+ 1.0/+ 0.6	2.75	-0.4	0.7	±0.10	32.7	-0.7	0.6	330	+ 1.5	3H30001	3H40001
8	+ 1.4/+ 0.7	3	-0.4	1	±0.15	43.53	-0.86	0.9	330	+ 1.5	3H30002	3H40002
10	+ 1.4/+ 0.7	5	-0.6	1.4	±0.15	54.41	-1.08	1.1	330	+ 1.5	3H30003	3H40003
12	+ 1.4/+ 0.7	6	-0.6	1.4	±0.15	65.3	-1.3	1.3	330	+ 1.5	3H30004	3H40004
14	+ 1.5/+ 0.7	7	-0.8	1.75	±0.20	76.18	-1.51	1.6	330	+ 1.5	3H30005	3H40005
16	+ 1.6/+ 0.7	8	-0.8	1.75	±0.20	87.06	-1.73	1.8	330	+ 1.5	3H30006	3H40006
18	+ 1.7/+ 0.7	9.55	-0.8	2	±0.25	97.95	-1.95	2	330	+ 1.5	3H30007	3H40007
20	+ 1.7/+ 0.7	10	-1	2	±0.25	108.83	-2.16	2.2	330	+ 1.5	3H30008	3H40008