

Carbide Dowels are solid pins, generally precision ground to narrow limits to permit accurate fitting. Precision dowels are used to hold parts together in a fixed alignment relying on the tightness of fit to stay in place.

Our stocked range includes carbide to ISO and DIN standards. Carbide dowel pins can manufacture to customer specifications and small diameter dowels are our specialty. We offer a fast-turnaround, competitive pricing, longer lengths up to 120mm (4.72inches), diameters up to 32mm (1-1/4 inches) and have experience across all industries.

Our engineers understand that not all standard dowel pins are appropriate for demanding applications or specialist projects, and it can be difficult to source the exact dowel for your specific needs. With our machining capabilities we can create a dowel pin designed to the purpose for which it is intended. Our following diameter and length are:

Diameter: 1.59mm to 32mm (1/16" to 1-1/4")

Length: 12.7mm to 120.00mm (0.5" to 4.72")

Diameter Tolerances: Generally from h6 to m6

Din6325 These dowel pins are supplied in hardened to 91.7-92.3HRA. They are manufactured in tungsten carbide.

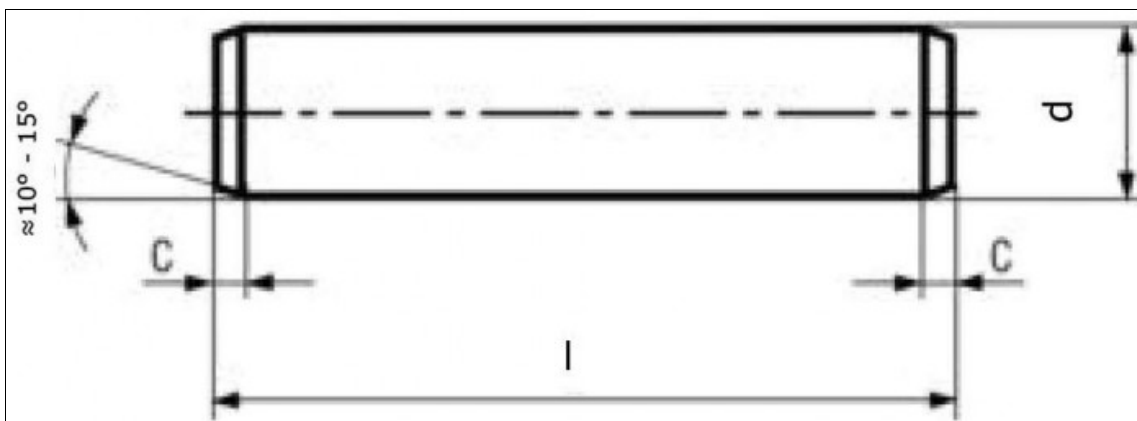

CARBIDETEK Inc.
Phone: +1-626-508-1014
Fax: +1-626-228-2482
E-mail: sales@carbideitek.com

Carbide Dowel Pins / Custom Dowel Pins



Basic Pin Diameter (d)		1/8	3/16	1/4	5/16	3/8	1/2	5/8	3/4	1
Diameter Code		005	009	014	016	018	024	026	028	034
Nominal		0.1250	0.1875	0.2500	0.3125	0.3750	0.5000	0.6250	0.7500	1.0000
Basic Diameter		0.1252	0.1877	0.2502	0.3127	0.3752	0.5002	0.6252	0.7502	1.0002
Pin Diameter max.		0.1253	0.1878	0.2503	0.3128	0.3753	0.5003	0.6253	0.7503	1.0003
Pin Diameter min.		0.1251	0.1876	0.2501	0.3126	0.3751	0.5001	0.6251	0.7501	1.0001
Crown Height		.041	.062	.083	.104	.125	.167	.208	.250	.333
Length (l)	Code	Pkg.								
3/8	0038	100								
1/2	0050	100	100	100	100					
5/8	0063	100	100	100	100	100				
3/4	0075	100	100	100	100	100	100			
7/8	0088	100	100	100	100	100	100			
1	0100	100	100	100	100	100	100	50		
1-1/4	0125	100	100	100	100	100	100	50		
1-1/2	0150	100	100	100	100	100	100	50	25	
1-3/4	0175	100	100	100	100	100	50	50		
2	0200		100	100	100	100	50	50	25	10
2-1/4	0225			100	100	100	50	50	25	
2-1/2	0250			100	100	100	50	50	25	10
3	0300			100	100	100	50	25	25	10
3-1/2	0350					100	25	25	10	10
4	0400					100	25	25	10	10
4-1/2	0450						25	25	10	5
5	0500						25	10	10	5

DOWEL DIAMETER TOLERANCES

Nominal Diameter

Dowel Diameter (m6)

0.8 mm	0.802-0.808
1.0 mm	1.002-1.008
1.5mm	1.502-1.508
2.0mm	2.002-2.008
2.5mm	2.502-2.508
3.0mm	3.002-3.008
4.0mm	4.004-4.012
5.0mm	5.004-5.012
6.0mm	6.004-6.012
8.0mm	8.006-8.015
10.0mm	10.006-10.015
12.0mm	12.007-12.018
14.0mm	14.007-14.018
16.0mm	16.007-16.018